

STIHL SPA 65

Instruction Manual



Contents

1	Introduction	2	10	Switching the Special Harvester On/Off	13
2	Guide to Using this Manual	2	10.1	Switching On	13
2.1	Applicable Documentation	2	10.2	Switching Off	13
2.2	Symbols used with warnings in the text	3	11	Checking the Special Harvester	14
2.3	Symbols in Text	3	11.1	Checking the Controls	14
3	Overview	3	11.2	Testing the Battery	14
3.1	Special Harvester and Battery	3	12	Operating the Special Harvester	14
3.2	Symbols	4	12.1	Holding and Controlling the Special Harvester	14
4	Safety Precautions	4	12.2	Adjusting Rake Speed for Continuous Duty Operation	15
4.1	Warning Signs	4	12.3	Harvesting	15
4.2	Intended Use	5	13	After Finishing Work	15
4.3	The Operator	5	13.1	After Finishing Work	15
4.4	Clothing and Equipment	6	14	Transporting	15
4.5	Work Area and Surroundings	6	14.1	Transporting the Special Harvester	15
4.6	Safe Condition	7	14.2	Transporting the Battery	15
4.7	Operation	8	15	Storing	16
4.8	Transporting	9	15.1	Storing the Special Harvester	16
4.9	Storing	10	15.2	Storing the Battery	16
4.10	Cleaning, Maintenance and Repairs	10	16	Cleaning	16
5	Preparing Special Harvester for Operation	11	16.1	Cleaning the Special Harvester	16
5.1	Preparing Special Harvester for Operation	11	16.2	Cleaning the Rakes and Tines	16
6	Charging the Battery, LEDs	11	16.3	Cleaning the Battery	16
6.1	Charging the Battery	11	17	Maintenance and Repairs	16
6.2	Displaying State of Charge	11	17.1	Servicing and Repairing the Special Harvester and Battery	16
6.3	LEDs on Battery	11	18	Troubleshooting	17
7	Assembling the Special Harvester	11	18.1	Troubleshooting Special Harvester and Battery	17
7.1	Fitting and Removing the Tines	11	19	Specifications	19
7.2	Mounting the Machine Support	12	19.1	STIHL SPA 65 Special Harvester	19
8	Adjusting Special Harvester for User	12	19.2	STIHL AP battery	19
8.1	Fitting and Adjusting the Carrying System	12	19.3	Noise and Vibration Data	19
9	Removing and Fitting the Battery	13	19.4	REACH	19
9.1	Fitting the Battery	13			
9.2	Removing the Battery	13			

STIHL®

This instruction manual is protected by copyright. All rights reserved, especially the rights to reproduce, translate and process with electronic systems.

20 Spare Parts and Accessories	19
20.1 Spare Parts and Accessories	19
21 Disposal	19
21.1 Disposing of Special Harvester and Battery	19
22 EC Declaration of Conformity	20
22.1 STIHL SPA 65 Special Harvester	20
23 General Power Tool Safety Warnings	20
23.1 Introduction	20
23.2 Work area safety	20
23.3 Electrical safety	21
23.4 Personal safety	21
23.5 Power tool use and care	21
23.6 Battery tool use and care	22
23.7 Service	22

1 Introduction

Dear Customer,

Thank you for choosing STIHL. We develop and manufacture our quality products to meet our customers' requirements. The products are designed for reliability even under extreme conditions.

STIHL also stands for premium service quality. Our specialist dealers guarantee competent advice and instruction as well as comprehensive service support.

We thank you for your confidence in us and hope you will enjoy working with your STIHL product.



Dr. Nikolas Stihl

IMPORTANT: READ BEFORE USE AND KEEP IN A SAFE PLACE.

2 Guide to Using this Manual

2.1 Applicable Documentation

Local safety regulations apply.

- Read, understand and save the following documents in addition to this instruction manual:
 - User instructions for STIHL AR battery
 - Instruction manual for AP belt bag with connecting cable
 - Safety notes and precautions for STIHL AP battery
 - Instruction manual for STIHL AL 101, 300, 500 chargers
 - Safety information for STIHL batteries and products with built-in batteries: www.stihl.com/safety-data-sheets

2.2 Symbols used with warnings in the text



WARNING

This symbol indicates dangers that can cause serious injuries or death.

- The measures indicated can avoid serious injuries or death.

NOTICE

This symbol indicates dangers that can cause damage to property.

- The measures indicated can avoid damage to property.

2.3 Symbols in Text



This symbol refers to a chapter in this instruction manual.

3 Overview

3.1 Special Harvester and Battery

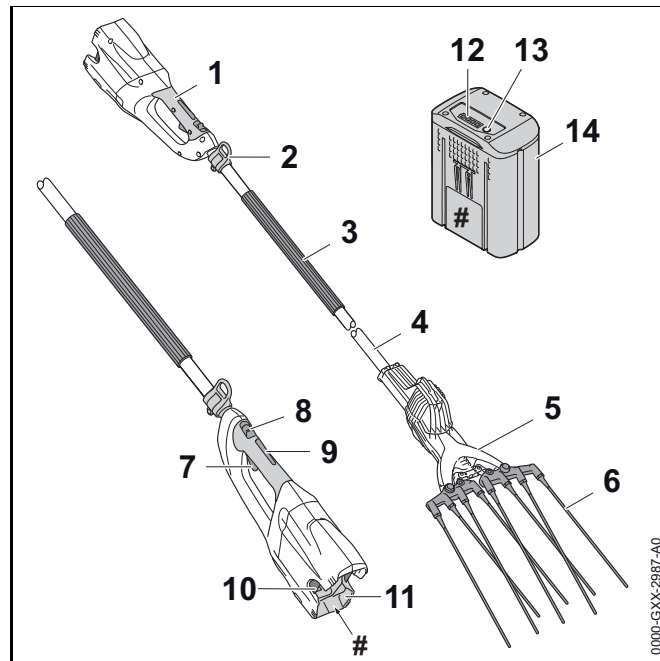

1 Control Handle

For operating, holding and controlling the special harvester.

2 Carrying Ring

For attaching a carrying system.

3 Handle Hose

For holding and controlling the special harvester.

4 Drive Tube

Connects all components.

5 Rakes

Transmit movement to tines.

- 6 Tines**
Shake the branches.
- 7 Trigger**
Switches the special harvester on and off.
- 8 Retaining Latch**
Operated together with the trigger lockout to unlock the trigger.
- 9 Trigger Lockout**
Operated together with the retaining latch to unlock the trigger.
- 10 Locking Lever**
Secures the battery in the battery compartment.
- 11 Battery Compartment**
Accommodates the battery.
- 12 Button**
Activates the LEDs on the battery.
- 13 LEDs**
Indicate battery's state of charge and malfunctions.
- 14 Battery**
Supplies power to the special harvester.

Rating label with serial number

3.2 Symbols

Meanings of symbols that may be on the special harvester and battery:

 Retaining latch unlocks the trigger in this position.

 Retaining latch locks the trigger in this position.

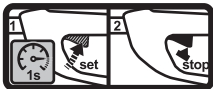
 Speed of rakes can be adjusted.

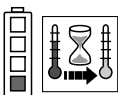
 1 LED glows red. Battery too hot or too cold.

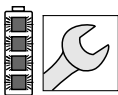
 4 LEDs flash red. There is a malfunction in the battery.

 **LWA** Guaranteed sound power level according to directive 2000/14/EC in dB(A) in order to make sound emissions of products comparable.

 The data next to this symbol indicates the energy content of the battery according to the cell manufacturer's specification. The energy content available during operation is lower.

 Do not dispose of the product with your household waste.

4 Safety Precautions

4.1 Warning Signs

Meanings of warning symbols on the special harvester and battery:

 Observe safety notices and take the necessary precautions.

 Read, understand and save the instruction manual.

 Wear safety glasses and a hard hat.



Wear work gloves.

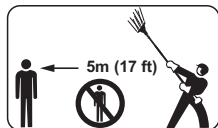

Maintain safe distance.



Always remove the battery during work breaks, transport, storage, maintenance or repairs.



Protect battery from heat and fire.



Do not immerse battery in fluids.



Observe battery's permissible temperature range.

4.2 Intended Use

The STIHL SPA 65 special harvester is designed to harvest olives, nuts and other fruits.

The special harvester may be used in the rain.

This special harvester is powered by a STIHL AP battery or a STIHL AR battery.

⚠ WARNING

- Batteries not explicitly approved for the special harvester by STIHL may cause a fire or explosion. This can result in serious or fatal injuries and damage to property.
 - ▶ Use the special harvester with a STIHL AP battery or a STIHL AR battery.
- Using the special harvester or the battery for purposes for which they were not designed may result in serious or fatal injuries and damage to property.
 - ▶ Use the special harvester as described in this instruction manual.
 - ▶ Use the battery as described in this instruction manual or the instruction manual for the STIHL AR battery.

4.3 The Operator

⚠ WARNING

- Users without adequate training or instruction cannot recognize or assess the risks involved in using the special harvester and battery. The user or other persons may sustain serious or fatal injuries.



- ▶ Read, understand and save the instruction manual.

- ▶ If you pass the special harvester or battery on to another person: Always give them the instruction manual.
- ▶ Make sure the user meets the following requirements:
 - The user must be rested.
 - The user must be in good physical condition and mental health to operate and work with the special harvester and battery. If the user's physical, sensory

or mental ability is restricted, he or she may work only under the supervision of or as instructed by a responsible person.

- The user must be legally recognized as an adult.
 - The user has received instruction from a STIHL servicing dealer or other experienced user before working with the special harvester for the first time.
 - The user must not be under the influence of alcohol, medication or drugs.
- If you have any queries: Contact your STIHL servicing dealer for assistance.

4.4 Clothing and Equipment

⚠ WARNING

- Long hair can be pulled into the special harvester during operation. This can result in serious injuries.
 - Tie up and confine long hair so that it cannot be entangled in the special harvester.

- Objects can be thrown through the air at high speed during operation. This can result in personal injury.



- Wear safety glasses. Suitable glasses that have been tested and labeled in accordance with EN 166 or national standards are available from retailers.

- Wear a long-sleeved, snug-fitting upper garment.

- Falling objects can cause head injuries.



- If there is a danger of falling objects during operation: Wear a safety hard hat.

- Dust can be whipped up during operation: Whipped up dust can damage the respiratory passages and cause allergic reactions.

- Wear a respirator.

- Unsuitable clothing can snag on wood, brush or the special harvester. Not wearing personal protective equipment may result in serious injury.

- Wear snug-fitting clothing.

- Do not wear a scarf or jewelry.

- Wearing unsuitable footwear may cause you to slip or stumble. This can result in personal injury.

- Wear sturdy footwear with non-slip soles.

4.5 Work Area and Surroundings

4.5.1 Special Harvester

⚠ WARNING

- Bystanders, children and animals cannot recognize or assess the dangers of the special harvester or flying debris. Innocent bystanders, children and animals may be seriously injured.



- Do not allow bystanders, children or animals within 5 meters of the work area.

- The special harvester's electric motor may produce sparks. Sparks may cause a fire or an explosion in an easily combustible or explosive environment. This can result in serious or fatal injuries and damage to property.

- Do not work in an easily combustible or explosive environment.

4.5.2 Battery

⚠ WARNING

- Children are not aware of and cannot assess the dangers of the battery and can be seriously injured.
 - ▶ Keep children away from the work area.
- The battery is not protected against all ambient conditions. If the battery is exposed to certain ambient conditions, it may catch fire or explode. This can result in serious injuries and damage to property.



- ▶ Protect battery from heat and fire.
- ▶ Do not throw the battery into a fire.



- ▶ Use and store the battery at temperatures between -10°C and +50°C.



- ▶ Do not immerse battery in fluids.

- ▶ Keep battery away from metallic objects.
- ▶ Do not expose battery to high pressure.
- ▶ Do not expose battery to microwaves.
- ▶ Protect battery from chemicals and salts.

4.6 Safe Condition

4.6.1 Special Harvester

The special harvester is in a safe condition if the following points are observed:

- The special harvester is not damaged.
- The special harvester is clean.
- The controls function properly and have not been modified.

- Only original STIHL accessories designed for this special harvester model are fitted.
- Accessories are properly mounted.

⚠ WARNING

- If components do not comply with safety requirements, they will no longer function properly and safety devices may be rendered inoperative. This can result in serious or fatal injuries.
 - ▶ Work only with an undamaged special harvester.
 - ▶ If the special harvester is dirty: Clean the harvester.
 - ▶ Do not modify the special harvester.
 - ▶ If the controls do not function properly: Do not work with the special harvester.
 - ▶ Only fit original STIHL accessories designed for this special harvester model.
 - ▶ Mount accessories as described in this instruction manual or the instructions supplied with the accessory.
 - ▶ Never insert objects in the special harvester's openings.
 - ▶ If you have any queries: Contact your STIHL servicing dealer for assistance.

4.6.2 Rakes

The rakes are in a safe condition if the following points are observed:

- The rakes and tines are not damaged.
- All tines are mounted.
- The tines are properly mounted.
- Only original STIHL accessories designed for these rakes are fitted.
- Accessories are properly mounted.

⚠ WARNING

- If components do not comply with safety requirements, they will no longer function properly and safety devices may be rendered inoperative. This can result in serious or fatal injuries.
 - ▶ Work with undamaged rakes and tines.
 - ▶ Mount all the tines.
 - ▶ Only fit original STIHL accessories designed for these rakes.
 - ▶ Mount accessories as described in this instruction manual or the instructions supplied with the accessory.

4.6.3 Battery

The battery is in a safe condition if the following points are observed:

- Battery is undamaged.
- Battery is clean and dry.
- Battery functions properly and has not been modified.

⚠ WARNING

- A battery that is not in a safe condition cannot operate safely. This can result in serious injuries.
 - ▶ Never work with a damaged battery.
 - ▶ Never attempt to charge a damaged or defective battery.
 - ▶ If the battery is dirty or wet: Clean the battery and allow it to dry.
 - ▶ Never attempt to modify the battery.
 - ▶ Never insert objects in the battery's openings.
 - ▶ Never bridge the battery's contacts with metallic objects (short circuit).
 - ▶ Do not open the battery.

- Fluid may escape from a damaged battery. The fluid can cause irritation if it contacts the skin or eyes.
 - ▶ Avoid contact with the fluid.
 - ▶ In case of contact with the skin: Wash affected areas with plenty of water and soap.
 - ▶ In case of contact with the eyes: Rinse eyes with plenty of water for at least 15 minutes and seek medical advice.
- A damaged or defective battery may smell unusual, emit smoke or burn. This can result in serious or fatal injuries and damage to property.
 - ▶ If the battery smells unusual or emits smoke: Do not use the battery and keep it away from combustible substances.
 - ▶ If the battery catches fire: Attempt to extinguish the battery with a fire extinguisher or water.

4.7 Operation

⚠ WARNING

- The user cannot concentrate on the work in certain situations. The user may stumble, fall and be seriously injured.
 - ▶ Work calmly and carefully.
 - ▶ If light and visibility are poor: Do not work with the special harvester.
 - ▶ Operate the special harvester alone.
 - ▶ Do not work above shoulder height.
 - ▶ Watch out for obstacles.
 - ▶ Stand on the ground while working and keep a good balance. If it is necessary to work at heights: Use a lift bucket or a safe platform.
 - ▶ If you begin to feel tired: Take a break.

- If the moving tines make contact with a hard object they can be brought to a sudden stop. The reactive forces that occur can cause the user to lose control of the special harvester and be seriously injured.
 - ▶ Hold the special harvester firmly with both hands.
- The moving rakes can seriously injure the user.
 - ▶ Do not touch the moving rakes.
- If the behavior of the special harvester changes during operation or feels unusual, it may no longer be in a safe condition. This can result in serious injuries and damage to property.
 - ▶ Stop work, remove the battery and contact your STIHL servicing dealer for assistance.
- Vibrations may occur while using the special harvester.



- ▶ Wear gloves.

- ▶ Take regular breaks.
- ▶ If signs of circulation problems occur: Seek medical advice.
- Note that the rakes continue to run for a short period after you release the trigger. This can result in serious injuries.
 - ▶ Wait until the rakes come to a complete standstill.
- In an emergency, the user may panic and not put the carrying system down. This can result in serious injuries.
 - ▶ Practice removing and putting down the carrying system.

4.8 Transporting

4.8.1 Special Harvester

⚠ WARNING

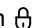
- The special harvester may turn over or shift during transport. This may result in personal injuries and damage to property.
 - ▶ Push the retaining latch into position .



- ▶ Remove the battery.

- ▶ Secure the special harvester to prevent turnover and movement.

4.8.2 Battery

⚠ WARNING

- The battery is not protected against all ambient conditions. The battery may be damaged if it is exposed to certain ambient conditions and damage to property may occur.
 - ▶ Never transport a damaged battery.
 - ▶ Store the battery in non-conductive packaging.
- The battery may turn over or shift during transport. This may result in personal injuries and damage to property.
 - ▶ Pack the battery in packaging in such a way that it cannot move.
 - ▶ Secure the packaging so that it cannot move.

4.9 Storing

4.9.1 Special Harvester

⚠ WARNING

- Children are not aware of and cannot assess the dangers of the special harvester and can be seriously injured.
 - ▶ Push the retaining latch into position .



- ▶ Remove the battery.

- ▶ Store the special harvester out of the reach of children.

- Dampness can corrode the electrical contacts on the special harvester and metal components. The special harvester can be damaged.
 - ▶ Push the retaining latch into position .



- ▶ Remove the battery.

- ▶ Store the special harvester in a clean and dry condition.

4.9.2 Battery

⚠ WARNING

- Children are not aware of and cannot assess the dangers of the battery and can be seriously injured.
 - ▶ Store the battery out of the reach of children.
- The battery is not protected against all ambient conditions. The battery may be damaged if it is exposed to certain ambient conditions.
 - ▶ Store the battery in a clean and dry condition.
 - ▶ Store the battery in an enclosed location.
 - ▶ Store the battery separately from the special harvester and charger.
 - ▶ Store the battery in non-conductive packaging.

- ▶ Store the battery at temperatures between -10°C and +50°C.

4.10 Cleaning, Maintenance and Repairs

⚠ WARNING

- The special harvester may start unintentionally if the battery is left in place during cleaning, maintenance or repair operations. This can result in serious injuries and damage to property.
 - ▶ Push the retaining latch into position .



- ▶ Remove the battery.

- Aggressive cleaning agents, pressure washers or pointed objects can damage the special harvester, rakes and battery. If the special harvester, rakes or battery are not cleaned correctly, components may no longer function properly or safety devices may be rendered inoperative. This can result in serious injuries.
 - ▶ Clean the special harvester, rakes and battery as described in this instruction manual.
- If the special harvester, rakes or battery are not serviced correctly, components may no longer function properly or safety devices may be rendered inoperative. This can result in serious or fatal injuries.
 - ▶ Do not attempt to service or repair the special harvester, rakes or battery.
 - ▶ If the special harvester, rakes or the battery require servicing or repairs: Contact your STIHL servicing dealer for assistance.

5 Preparing Special Harvester for Operation

5.1 Preparing Special Harvester for Operation

Perform the following steps before starting work:

- ▶ Make sure the following components are in a safe condition:
 - Special harvester, 4.6.1.
 - Rakes, 4.6.2.
 - Battery, 4.6.3.
- ▶ Check the battery, 11.2.
- ▶ Recharge the battery fully as described in the instruction manual for the STIHL AL 101, 300, 500 chargers.
- ▶ Clean the special harvester, 16.1.
- ▶ Fit the tines, 7.1.1.
- ▶ Fit the machine support, 7.2.
- ▶ Fit and adjust the carrying system, 8.
- ▶ Check the controls, 11.
 - ▶ If 3 LEDs flash red while you are checking the controls: Remove the battery and contact your STIHL dealer for assistance.
There is a malfunction in the special harvester.
- ▶ If you cannot carry out this work: Do not use your special harvester and contact your STIHL servicing dealer for assistance.

6 Charging the Battery, LEDs

6.1 Charging the Battery

The charging time depends on several factors, e.g. temperature of the battery or the ambient temperature. The actual charging time may differ from the specified charging time. For specified charging times see www.stihl.com/charging-times.

- ▶ Recharge the battery fully as described in the instruction manual for the STIHL AL 101, 300, 500 chargers.

6.2 Displaying State of Charge

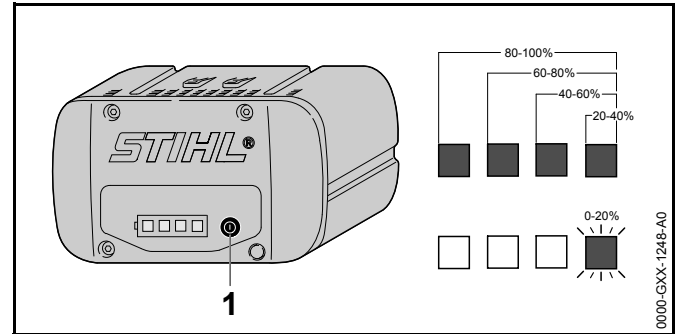

- ▶ Press the button (1).
The LEDs (5) glow green for about 5 seconds and indicate the state of charge.
- ▶ If the LED on the right flashes green: Charge the battery.

6.3 LEDs on Battery

The LEDs can show the state of charge or malfunctions. The LEDs can glow or flash green or red.

The state of charge is indicated when the LEDs glow or flash green.

- ▶ If the LEDs glow or flash red: Troubleshooting, 18.
There is a malfunction in the special harvester or battery.

7 Assembling the Special Harvester

7.1 Fitting and Removing the Tines

7.1.1 Fitting the Tines

- ▶ Switch off the special harvester, push retaining latch to position and remove the battery.

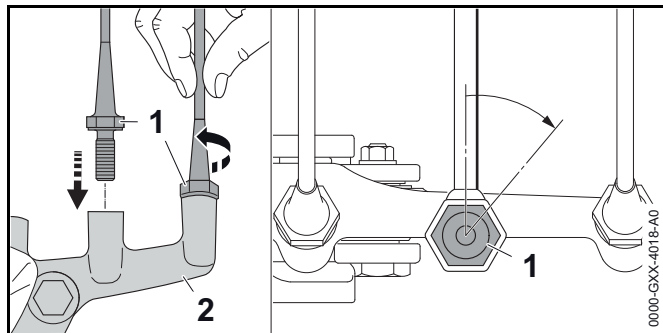

- Screw the tine (1) into the rake (2) and tighten it down firmly by hand.
- Use a 16 mm ring wrench to turn the tine (1) another 1/8 turn.

7.1.2 Removing the Tines

- Switch off the special harvester, push retaining latch to position  and remove the battery.
- Loosen tine with a 16 mm ring wrench.
- Unscrew the tine by hand.

7.2 Mounting the Machine Support

- Switch off the special harvester, push retaining latch to position  and remove the battery.

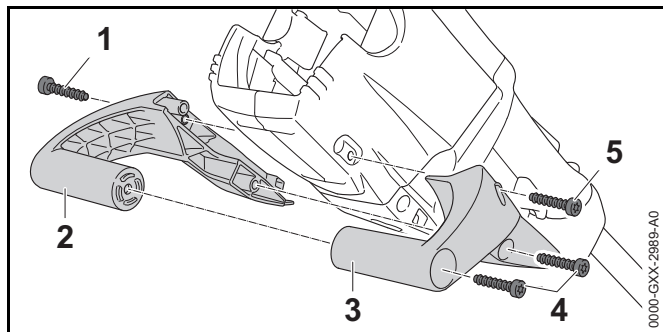

- Position the left half of the machine support (2) against the side of the cover.
- Fit the screw (1).

- Position the right half of the machine support (4) against the side of the cover.
 - Fit the screw (5).
 - Insert and tighten down the screws (4) firmly.
 - Tighten down the screws (1) and (5) firmly.
- The machine support (2) need not be removed again.

8 Adjusting Special Harvester for User

8.1 Fitting and Adjusting the Carrying System

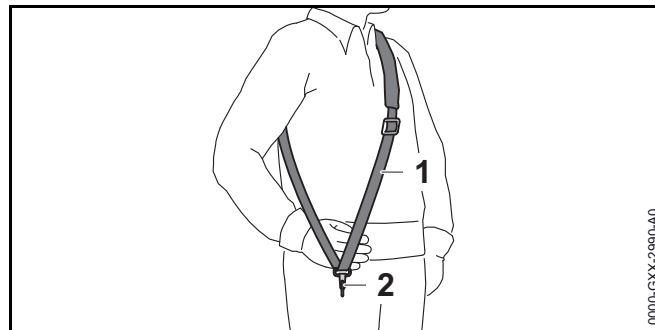

- Put on the shoulder strap (1).
- Adjust the shoulder strap (1) so that the carabiner (2) is about a hand's width below your right hip.

9 Removing and Fitting the Battery

9.1 Fitting the Battery

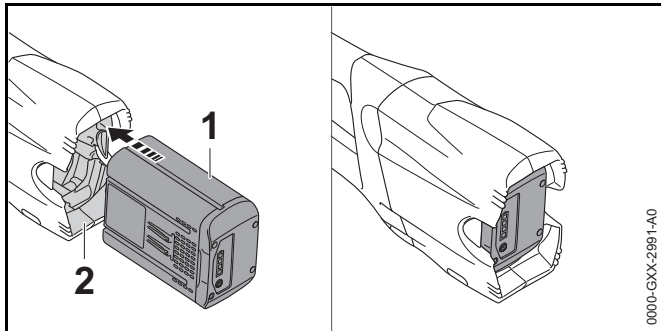

- ▶ Push the battery (1) into the battery compartment (2) as far as stop.
The battery (1) engages in position with a click.

9.2 Removing the Battery

- ▶ Place the special harvester on a level surface.
- ▶ Hold one hand in front of the battery compartment to ensure the battery (2) does not fall out.

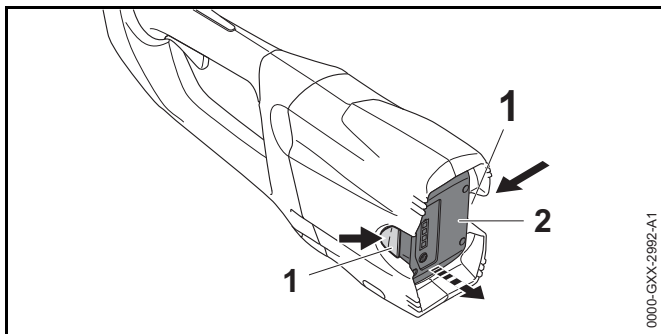

- ▶ Depress both locking levers (1).
The battery (2) is unlocked and can be removed.

10 Switching the Special Harvester On/Off

10.1 Switching On

- ▶ Hold the special harvester with one hand on the control handle – wrap your thumb around the control handle.
- ▶ Hold the special harvester firmly with your other hand on the handle hose - wrap your thumb around the handle hose.

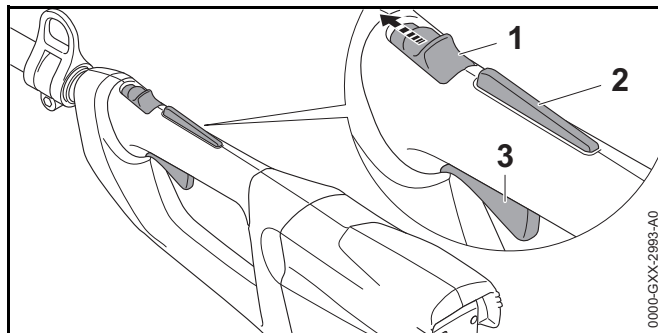

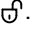
- ▶ Push the retaining latch (1) with your thumb to position .
- ▶ Depress the trigger lockout (2) with your hand and hold it there.
- ▶ Pull the trigger (3) with your index finger and hold it there.
The motor accelerates and the rakes run.

The more you depress the trigger (3), the faster the rakes run.

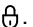

10.2 Switching Off

- ▶ Pull the trigger all the way and then let it go.
- ▶ Wait until the rakes come to a complete standstill.
- ▶ If the rakes do not stop running after a brief delay:
Remove the battery and contact your STIHL dealer for assistance.
The special harvester is defective.
- ▶ Push the retaining latch into position .

11 Checking the Special Harvester

11.1 Checking the Controls

Retaining latch, trigger lockout and trigger

- ▶ Remove the battery.
- ▶ Push the retaining latch into position .
- ▶ Attempt to pull the trigger without depressing the lockout lever.
- ▶ If the trigger can be pulled: Do not use your special harvester and contact your STIHL servicing dealer for assistance.
Retaining latch or trigger lockout is faulty.
- ▶ Push the retaining latch into position .
- ▶ Depress the trigger lockout lever and hold it in that position.
- ▶ Pull the trigger.
- ▶ Release the trigger and trigger lockout lever.
- ▶ If the trigger or trigger lockout is stiff or does not spring back to the idle position: Do not use your special harvester and contact your STIHL servicing dealer for assistance.
Trigger or trigger lockout is faulty.

Switching On

- ▶ Fit the battery.
- ▶ Depress the trigger lockout lever and hold it in that position.
- ▶ Pull the trigger and hold it there.
The rakes run.
- ▶ If 3 LEDs flash red: Remove the battery and contact your STIHL dealer for assistance.
There is a malfunction in the special harvester.
- ▶ Release the trigger.
The rakes stop running after a brief delay.
- ▶ If the rakes do not stop running after a brief delay:
Remove the battery and contact your STIHL dealer for assistance.
The special harvester is defective.

11.2 Testing the Battery

- ▶ Press button on battery.
The LEDs glow or flash.
- ▶ If the LEDs do not glow or flash: Do not use the battery and contact your STIHL servicing dealer.
There is a malfunction in the battery.

12 Operating the Special Harvester

12.1 Holding and Controlling the Special Harvester

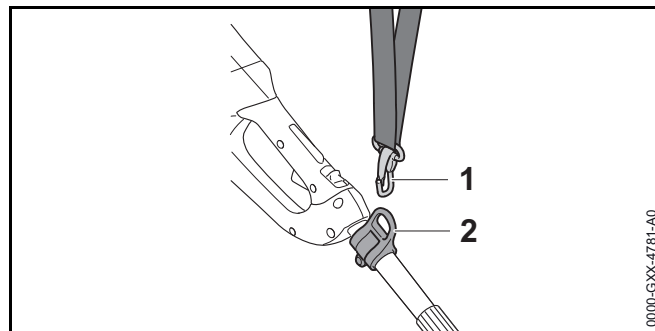

- ▶ Connect the carrying ring (2) to the carabiner (1).

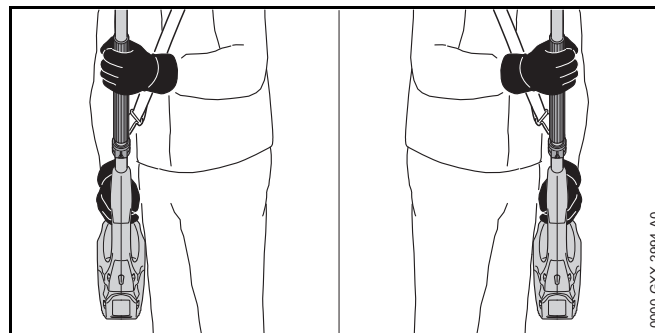

- ▶ Hold the special harvester with one hand on the control handle – wrap your thumb around the control handle.
- ▶ Hold the special harvester firmly with your other hand on the handle hose - wrap your thumb around the handle hose.

12.2 Adjusting Rake Speed for Continuous Duty Operation

The speed of the rakes is infinitely variable with the trigger. The more you depress the trigger, the faster the rakes run.

- ▶ Depress the trigger until the required rake speed is reached and hold the trigger in that position for more than 1 second.
You can let go of the trigger. The rake speed is set and maintained.
- ▶ If you want to change the speed:
 - ▶ Pull the trigger all the way and then let it go.
 - ▶ Readjust rake speed for continuous duty operation.

12.3 Harvesting

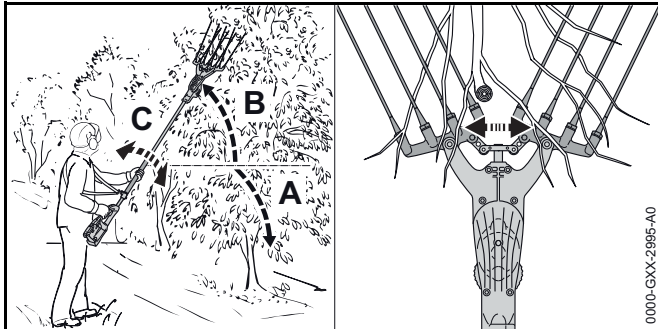

- ▶ Comb the lower section (A) and hanging branches on the outside of the tree from the top downwards.
- ▶ Comb the upper section (B) from the bottom upwards.
- ▶ Comb the tree from the inside outwards, towards the tips of the branches (C).

13 After Finishing Work

13.1 After Finishing Work

- ▶ Switch off the special harvester, push retaining latch to position  and remove the battery.

- ▶ If the special harvester is wet: Allow the special harvester to dry.
- ▶ Clean the harvester.
- ▶ Clean the rakes and tines.
- ▶ Clean the battery.

14 Transporting

14.1 Transporting the Special Harvester

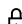
- ▶ Switch off the special harvester, push retaining latch to position  and remove the battery.
- ▶ Carry the special harvester with one hand on the handle hose and the rakes behind you.
- ▶ Transporting the special harvester in a vehicle: Make sure the special harvester cannot turn over or move.

14.2 Transporting the Battery

- ▶ Switch off the special harvester and remove the battery.
- ▶ Make sure the battery is in a safe condition.
- ▶ Observe the following points when packing the battery:
 - The packaging must be non-conductive.
 - Make sure the battery cannot shift inside the packaging.
- ▶ Secure the packaging so that it cannot move.

The battery is subject to the requirements for the transport of dangerous goods. The battery is classified as UN 3480 (lithium-ion batteries) and has been tested in accordance with UN Manual of Tests and Criteria, Part III, sub-section 38.3.

For transport regulations see www.stihl.com/safety-data-sheets

15 Storing

15.1 Storing the Special Harvester

- ▶ Switch off the special harvester, push retaining latch to position  and remove the battery.
- ▶ Check the following points when storing the special harvester:
 - Special harvester is out of the reach of children.
 - Special harvester is clean and dry.

15.2 Storing the Battery

STIHL recommends that you store the battery with a charge between 40% and 60% (2 LEDs glow green).

- ▶ Check the following points when storing the battery:
 - Battery is out of the reach of children.
 - Battery is clean and dry.
 - Battery is in an enclosed location.
 - Battery is stored separately from the special harvester and charger.
 - Battery is in non-conductive packaging.
 - Battery is in a temperature range between -10°C and +50°C.

16 Cleaning

16.1 Cleaning the Special Harvester

- ▶ Switch off the special harvester, push retaining latch to position  and remove the battery.
- ▶ Clean the special harvester with a damp cloth or STIHL resin solvent.

16.2 Cleaning the Rakes and Tines

- ▶ Switch off the special harvester, push retaining latch to position  and remove the battery.

- ▶ Clean the rakes and tines with a damp cloth or STIHL resin solvent.

16.3 Cleaning the Battery

- ▶ Clean the battery with a damp cloth.

17 Maintenance and Repairs

17.1 Servicing and Repairing the Special Harvester and Battery

The special harvester cannot be serviced or repaired by the user.

- ▶ If the special harvester is damaged: Do not use your special harvester and contact your STIHL servicing dealer for assistance.
- ▶ If the battery has a malfunction or is damaged: Replace the battery.

18 Troubleshooting

18.1 Troubleshooting Special Harvester and Battery

Condition	LEDs on Battery	Cause	Remedy
Special harvester does not run when switched on.	1 LED flashes green	Battery has low charge.	<ul style="list-style-type: none"> ▶ Recharge the battery fully as described in the instruction manual for the STIHL AL 101, 300, 500 chargers.
	1 LED glows red.	Battery too hot or too cold.	<ul style="list-style-type: none"> ▶ Remove the battery. ▶ Allow battery to cool down / warm up.
	3 LEDs flash red.	There is a malfunction in the special harvester.	<ul style="list-style-type: none"> ▶ Remove the battery. ▶ Clean contacts in battery compartment. ▶ Fit the battery. ▶ Switch on the special harvester. ▶ If 3 LEDs continue to flash red: Do not use your special harvester and contact your STIHL servicing dealer for assistance.
		Rakes do not move freely.	<ul style="list-style-type: none"> ▶ Spray both sides of rakes with STIHL resin solvent. ▶ If 3 LEDs continue to flash red: Do not use your special harvester and contact your STIHL servicing dealer for assistance.
	3 LEDs glow red	Special harvester is too hot.	<ul style="list-style-type: none"> ▶ Remove the battery. ▶ Allow the special harvester to dry.
	4 LEDs flash red.	There is a malfunction in the battery.	<ul style="list-style-type: none"> ▶ Remove battery and insert it again. ▶ Switch on the special harvester. ▶ If 4 LEDs continue to flash red: Do not use the battery and contact your STIHL dealer for assistance.
		No electrical contact between special harvester and battery.	<ul style="list-style-type: none"> ▶ Remove the battery. ▶ Clean contacts in battery compartment. ▶ Fit the battery.
		Special harvester or battery damp.	<ul style="list-style-type: none"> ▶ Allow the special harvester or battery to dry.
Special harvester cuts out during operation.	3 LEDs glow red	Special harvester is too hot.	<ul style="list-style-type: none"> ▶ Remove the battery. ▶ Allow the special harvester to dry.

Condition	LEDs on Battery	Cause	Remedy
		There is a electrical malfunction.	<ul style="list-style-type: none">▶ Remove battery and insert it again.▶ Switch on the special harvester.
Special harvester runtime is too short		Battery not fully charged.	<ul style="list-style-type: none">▶ Recharge the battery fully as described in the instruction manual for the STIHL AL 101, 300, 500 chargers.
		Normal battery life has been exceeded.	<ul style="list-style-type: none">▶ Replace the battery.

19 Specifications

19.1 STIHL SPA 65 Special Harvester

- Approved batteries:
 - STIHL AP
 - STIHL AR
- Weight without battery: 3.3 kg
- Length: 2.26 m

19.2 STIHL AP battery

- Battery Technology: Lithium-ion
- Voltage: 36 V
- Capacity in Ah: see rating label
- Energy content in Wh: see rating label
- Weight in kg: see rating label
- Permissible temperature range for operation and storage:
 - -10°C to +50°C

19.3 Noise and Vibration Data

STIHL recommends that you wear hearing protection.

- Sound pressure level L_{pA} measured according to ISO 22868: 84 dB(A) K-value for noise pressure level is 2 dB(A).
- Sound power level L_{WA} measured according to ISO 22868: 95 dB(A) K-value for sound power level is 2 dB(A).
- Vibration level a_{HV} measured according to EN 60745-2-13;
 - Control handle: 2.5 m/s² K-value for vibration level is 2 m/s².
 - Loop handle: 2.5 m/s² K-value for vibration level is 2 m/s².

The vibration values quoted above have been measured according to a standardized test procedure and may be used to compare electric power tools. Depending on the type of usage, the vibrations that actually occur may differ from the values quoted. The vibration values quoted may be used for an initial assessment of the user's exposure to vibrations. The actual exposure to vibrations has to be estimated. This process may also take into account times during which the electric power tool is switched off and times during which it is switched on but running off load.

19.4 REACH

REACH is an EC regulation and stands for the Registration, Evaluation, Authorisation and Restriction of Chemical substances.

For information on compliance with the REACH regulation see www.stihl.com/reach.

20 Spare Parts and Accessories

20.1 Spare Parts and Accessories

STIHL® These symbols identify original STIHL replacement parts and original STIHL accessories.



STIHL recommends the use of original STIHL replacement parts and accessories.

Original STIHL replacement parts and original STIHL accessories are available from STIHL servicing dealers.

21 Disposal

21.1 Disposing of Special Harvester and Battery

Information on disposal is available from STIHL servicing dealers.

- Dispose of the special harvester, battery, accessories and packaging in accordance with local regulations and environmental requirements.

22 EC Declaration of Conformity

22.1 STIHL SPA 65 Special Harvester

ANDREAS STIHL AG & Co. KG

Badstrasse 115

D-71336 Waiblingen

Germany

declare in exclusive responsibility that

- Category: Cordless special harvester
- Make: STIHL
- Model: SPA 65
- Serial identification: 4855

conforms to the relevant provisions of Directives 2011/65/EU, 2006/42/EC, 2014/30/EU and 2000/14/EC and has been developed and manufactured in compliance with the following standards in the versions valid on the date of production: EN 55014-1, EN 55014-2 and EN 60745-1.

Technical documents are deposited at ANDREAS STIHL AG & Co. KG Produktzulassung (Product Licensing).

The year of manufacture, country of manufacture and serial number are applied to the special harvester.

Done at Waiblingen, 01.03.2017

ANDREAS STIHL AG & Co. KG



Thomas Elsner, Director Product Management and Services

23 General Power Tool Safety Warnings

23.1 Introduction

This chapter reproduces the pre-formulated, general safety precautions specified in the IEC 60745 standard for hand-held motor-operated electric tools.

STIHL is obliged to publish these texts.

The safety precautions and warnings on avoiding an electric shock given under "2) Electric Precautions" do not apply to STIHL cordless electric power tools.



WARNING

Read all safety warnings and instructions. Failure to follow the warnings and instructions may result in electric shock, fire and/or serious injury. **Save all warnings and instructions for future reference.**

The term "power tool" in the warnings refers to your mains-operated (corded) power tool or battery-operated (cordless) power tool.

23.2 Work area safety

- Keep work area clean and well lit.** Cluttered or dark areas invite accidents.
- Do not operate power tools in explosive atmospheres, such as in the presence of flammable liquids, gases or dust.** Power tools create sparks which may ignite the dust or fumes.
- Keep children and bystanders away while operating a power tool.** Distractions can cause you to lose control.

23.3 Electrical safety

- a) **Power tool plugs must match the outlet. Never modify the plug in any way. Do not use any adapter plugs with earthed (grounded) power tools.** Unmodified plugs and matching outlets will reduce risk of electric shock.
- b) **Avoid body contact with earthed or grounded surfaces, such as pipes, radiators, ranges and refrigerators.** There is an increased risk of electric shock if your body is earthed or grounded.
- c) **Do not expose power tools to rain or wet conditions.** Water entering a power tool will increase the risk of electric shock.
- d) **Do not abuse the cord. Never use the cord for carrying, hanging up, pulling or unplugging the power tool. Keep cord away from heat, oil, sharp edges or moving parts.** Damaged or entangled cords increase the risk of electric shock.
- e) **When operating a power tool outdoors, use an extension cord suitable for outdoor use.** Use of a cord extension suitable for outdoor use reduces the risk of electric shock.
- f) **If operating a power tool in a damp location is unavoidable, use a residual current device (RCD) protected supply.** Use of an RCD reduces the risk of electric shock.

23.4 Personal safety

- a) **Stay alert, watch what you are doing and use common sense when operating a power tool. Do not use a power tool while you are tired or under the influence of drugs, alcohol or medication.** A moment of inattention while operating power tools may result in serious personal injury.
- b) **Use personal protective equipment. Always wear eye protection.** Protective equipment such as dust mask, non-skid safety shoes, hard hat, or hearing protection used for appropriate conditions will reduce personal injuries.
- c) **Prevent unintentional starting. Ensure the switch is in the off position before connecting to power source and/or battery pack, picking up or carrying the power tool.**

Carrying power tools with your finger on the switch or energising power tools that have the switch on invites accidents.

- d) **Remove any adjusting key or wrench before turning the power tool on.** A wrench or a key left attached to a rotating part of the power tool may result in personal injury.
- e) **Do not overreach. Keep proper footing and balance at all times.** This enables better control of the power tool in unexpected situations.
- f) **Dress properly. Do not wear loose clothing or jewellery. Keep your hair, clothing and gloves away from moving parts.** Loose clothes, jewellery or long hair can be caught in moving parts.
- g) **If devices are provided for the connection of dust extraction and collection facilities, ensure these are connected and properly used.** Use of dust collection can reduce dust-related hazards.
- h) **Do not let familiarity gained from frequent use of tools allow you to become complacent and ignore tool safety principles.** A careless action can cause severe injury within a fraction of a second.

23.5 Power tool use and care

- a) **Do not force the power tool. Use the correct power tool for your application.** The correct power tool will do the job better and safer at the rate for which it was designed.
- b) **Do not use the power tool if the switch does not turn it on and off.** Any power tool that cannot be controlled with the switch is dangerous and must be repaired.
- c) **Disconnect the plug from the power source and/or remove the battery pack, if detachable, from the power tool before making any adjustments, changing accessories, or storing power tools.** Such preventive safety measures reduce the risk of starting the power tool accidentally.
- d) **Store idle power tools out of the reach of children and do not allow persons unfamiliar with the power tool or these instructions to operate the power tool.** Power tools are dangerous in the hands of untrained users.

- e) **Maintain power tools and accessories. Check for misalignment or binding of moving parts, breakage of parts and any other condition that may affect the power tool's operation. If damaged, have the power tool repaired before use.** Many accidents are caused by poorly maintained power tools.
- f) **Keep cutting tools sharp and clean.** Properly maintained cutting tools with sharp cutting edges are less likely to bind and are easier to control.
- g) **Use the power tool, accessories, tool bits etc. in accordance with these instructions, taking into account the working conditions and the work to be performed.** Use of the power tool for operations different from those intended could result in a hazardous situation.
- h) **Keep handles and grip surfaces dry, clean and free from oil and grease.** Slippery handles and grip surfaces do not allow proper operation and control of the power tool in unforeseen situations.

23.6 Battery tool use and care

- a) **Recharge only with the charger specified by the manufacturer.** A charger that is suitable for one type of battery pack may create a risk of fire when used with another battery pack.
- b) **Use power tools only with specifically designated battery packs.** Use of any other battery packs may create a risk of injury and fire.
- c) **When battery pack is not in use, keep it away from other metal objects, like paper clips, coins, keys, nails, screws or other small objects that can make a connection from one terminal to another.** Shorting the battery terminals together may cause burns or a fire.
- d) **Under abusive conditions, liquid may be ejected from the battery; avoid contact. If contact accidentally occurs, flush with water. If liquid contacts eyes, additionally seek medical help.** Liquid ejected from the battery may cause irritation or burns.

- e) **Do not use a battery pack or tool that is damaged or modified.** Damaged or modified batteries may exhibit unpredictable behaviour resulting in fire, explosion or risk of injury.
- f) **Do not expose a battery pack or tool to fire or excessive temperature.** Exposure to fire or temperature above 130 °C (265 °F) may cause explosion.
- g) **Follow all charging instructions and do not charge the battery pack or tool outside the temperature range specified in the instructions.** Charging improperly or at temperatures outside the specified range may damage the battery and increase the risk of fire.

23.7 Service

- a) **Have your power tool serviced by a qualified repair person using only identical replacement parts.** This will ensure that the safety of the power tool is maintained.
- b) **Never service damaged batteries.** Service of battery packs should only be performed by the manufacturer or authorized service providers.

0458-704-0121-A

englisch



www.stihl.com



0458-704-0121-A